

Saint-Gobain Rulon Product Brochure

V2021JAN



20.1 Rulon High-Temperature Polymer

Saint-Gobain Performance Plastics produces various polymer products like ptfе bearings, teflon slide bearing namely Rulon®, Meldin®, Hycomp, HKO and OmniSeal®. These high performance products are served to a number of industries like Steel, Chemical, Food and Beverages, Aerospace, Automotive etc. The advantage of these Performance Plastics is that they can be used to produce required products like bushings, liners, etc. with required dimensions.

Table of contents

20.1 Rulon High-Temperature Polymer 20.1 - 20.6

20.1.1	Rulon® AR	20.1
20.1.2	Rulon® LR	20.1
20.1.3	Rulon® J	20.2
20.1.4	Rulon® 641	20.2
20.1.5	Rulon® W2	20.2
20.1.6	Rulon® 123	20.3
20.1.7	Rulon® 488	20.3
20.1.8	Rulon® 957	20.3
20.1.9	Rulon® XL	20.4
20.1.10	Rulon® 142	20.4
20.1.11	Rulon® 945	20.4
20.1.12	Rulon® 1045	20.5
20.1.13	Rulon® 1337	20.5
20.1.14	Rulon® 1410	20.5
20.1.15	Rulon® 1439	20.6

20.1 Rulon High-Temperature Polymer

Rulon® is a fluoropolymer containing pigments and fillers which makes its performance different than any conventional polymer material. PTFE bearing capacity of Rulon® is comparatively high. It features dielectric and thermal insulation. Its temperature and chemical resistance makes it FDA compliant and also used in many industries like Automotive, Pharmaceutical, Consumer Goods, Machine Tools, etc. There are grades like Rulon® AR, Rulon® LR, Rulon® J, Rulon® 641 for different operating conditions and applications. Few examples are Saint-Gobain Rulon® 945 COLLAR: PPX961 and Saint-Gobain Rulon® 945 RING: PPX962 are used in the Rolling mill section in Divider Roll Assembly of the Pickling tank.

20.1.1 RULON® AR



Product application

- Pumps
- Mixers
- Compressors
- Appliances
- Automotive
- Insulators
- Linear slides
- Pipe support
- Wear bands

Industries it caters to

- Automotive
- Pump Manufacturer
- Aerospace

Selection parameters

Parameters	Min	Max
Temperature - Typical Range	-240 °C	288 °C
Maximum speed	-	2 m/s
Maximum Pressure	-	6.9 MPa

20.1.2 RULON® LR



Product application

- Pumps
- Mixers
- Compressors
- Appliances
- Automotive
- Insulators
- Linear slides
- Pipe support
- Wear bands

Industries it caters to

- Automotive
- Pump Manufacturer
- Aerospace
- Textile Equipment Manufacturer

Selection parameters

Parameters	Min	Max
Temperature - Typical Range	-240 °C	288 °C
Maximum speed	-	-
Maximum Pressure	-	6.9 MPa

20.1 Rulon High-Temperature Polymer (continued)

20.1.3 RULON® J



Product application

- Printers
- Copiers
- Air Compressors
- Appliances
- Insulators
- Linear Slides
- Anemometers
- Wear Bands
- Solenoid Valves
- Refrigeration Valves

Industries it caters to

- Automotive
- Aerospace
- Textile Equipment Manufacturer

Selection parameters

Parameters	Min	Max
Temperature - Typical Range	-240 °C	288 °C
Maximum speed	-	-
Maximum Pressure	-	5.2 MPa

20.1.4 RULON® 641



Product application

- Pumps
- Mixers
- Compressors
- Appliances
- Chute Liners
- Insulators
- Linear Slides
- Shaft Bearings
- Wear Bands
- Seals

Industries it caters to

- Pump Manufacturer
- Automotive

Selection parameters

Parameters	Min	Max
Temperature - Typical Range	-240 °C	288 °C
Maximum speed	-	2 m/s
Maximum Pressure	-	6.9 MPa

20.1.5 RULON® W2



Product application

- Pumps
- Mixers
- Compressors
- Appliances
- Thrust Bearings
- Plating Tanks
- Wear Bands
- Ovens

Industries it caters to

- Pump Manufacturer
- Automotive

Selection parameters

Parameters	Min	Max
Temperature - Typical Range	-240 °C	288 °C
Maximum speed	-	2 m/s
Maximum Pressure	-	6.9 MPa

20.1 Rulon High-Temperature Polymer (continued)

20.1.6 RULON® 123



Product application

- Pumps
- Mixers
- Compressors
- Appliances
- Automotive Lip Seals
- Liners
- Linear Slides
- Pipe Supports
- Wear Bands
- Dust Seals
- Solenoid Valves
- TPS Shaft Seals
- EGR Valves

Industries it caters to

- Automotive
- Aerospace
- Textile Equipment Manufacturer

Selection parameters

Parameters	Min	Max
Temperature - Typical Range	-240 °C	288 °C
Maximum speed	-	2 m/s
Maximum Pressure	-	6.9 MPa

20.1.7 RULON® 488



Product application

- Pumps
- Insulators
- Appliances
- Compressors
- Mixers
- Linear Slides
- Pipe Support
- Wear Bands

Industries it caters to

- Automotive
- Pump Manufacturer

Selection parameters

Parameters	Min	Max
Temperature - Typical Range	-240 °C	288 °C
Maximum speed	-	2 m/s
Maximum Pressure	-	6.9 MPa

20.1.8 RULON® 957



Product application

- Clothes Dryers
- Mixers
- Compressors
- Ovens and Dryers
- Insulators
- Linear Slides
- Sanders
- Wear Bands

Industries it caters to

- Automotive

Selection parameters

Parameters	Min	Max
Temperature - Typical Range	-240 °C	288 °C
Maximum speed	-	2 m/s
Maximum Pressure	-	6.9 MPa

20.1 Rulon High-Temperature Polymer (continued)

20.1.9 RULON® XL

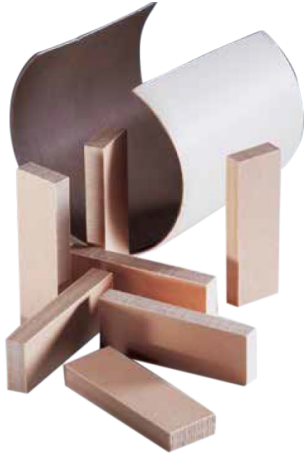

Product application

- Vacuum Pumps
- Mixers
- Compressors
- Appliances
- Linear Slides
- Insulators
- Shaft Support
- Wear Bands

Industries it caters to

- Automotive
- Pump Manufacturer

Selection parameters

Parameters	Min	Max
Temperature - Typical Range	-240 °C	288 °C
Maximum speed	-	2 m/s
Maximum Pressure	-	8.3 MPa

20.1.10 RULON® 142

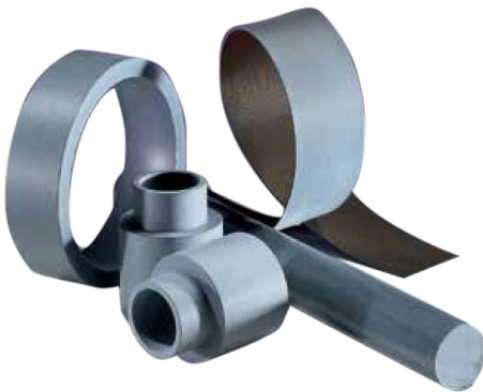

Product application

- Lathes
- Gibs, Guideways
- Compressors
- Appliances
- Rotary Tables
- Motor Mounts
- Linear Slides
- Pipe Supports
- Hydraulic Presses

Industries it caters to

- Machine Tool Manufacturer
- Automotive

Selection parameters

Parameters	Min	Max
Temperature - Typical Range	-240 °C	288 °C
Maximum speed	-	2 m/s
Maximum Pressure	-	6.9 MPa

20.1.11 RULON® 945



Product application

- Pumps
- Mixers
- Compressors
- Appliances
- Insulators
- Linear Slides
- Pipe Supports
- Wear Bands

Industries it caters to

- Pump Manufacturer
- Automotive
- Aerospace

Selection parameters

Parameters	Min	Max
Temperature - Typical Range	-240 °C	288 °C
Maximum speed	-	2 m/s
Maximum Pressure	-	8.3 MPa

20.1 Rulon High-Temperature Polymer (continued)

20.1.12 RULON® 1045



Product application

- AC Compressors
- Transmissions
- Air compressors
- Appliances
- Linear Slides
- Fluid Transfer Systems
- Vacuum Pumps
- Valves"

Industries it caters to

- Automotive
- Pump Manufacturer

Selection parameters

Parameters	Min	Max
Temperature - Typical Range	-240 °C	288 °C
Maximum speed	-	2 m/s
Maximum Pressure	-	6.9 MPa

20.1.13 RULON® 1337

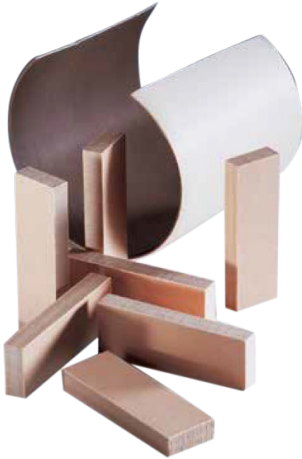

Product application

- Pumps
- Mixers
- Compressors
- Appliances
- Chute Liners
- Insulators
- Linear Slides
- Shaft Bearings
- Wear Bands
- Seals

Industries it caters to

- Pump Manufacturer
- Automotive

Selection parameters

Parameters	Min	Max
Temperature - Typical Range	-240 °C	288 °C
Maximum speed	-	2 m/s
Maximum Pressure	-	6.9 MPa

20.1.14 RULON® 1410



Product application

- AC Compressors
- Transmissions
- Air Compressors
- Appliances
- Linear Slides
- Fluid Transfer Systems
- Vacuum Pumps
- Valves

Industries it caters to

- Automotive
- Pump Manufacturer

Selection parameters

Parameters	Min	Max
Temperature - Typical Range	-240 °C	288 °C
Maximum speed	-	2 m/s
Maximum Pressure	-	5.2 MPa

20.1 Rulon High-Temperature Polymer (continued)

20.1.15 RULON® 1439



Product application

- Transmissions
- Air Compressors
- Appliances
- Pillow Blocks
- Linear Slides
- Fluid Transfer Systems
- Vacuum Pumps
- Valves

Industries it caters to

- Automotive
- Pump Manufacturer

Selection parameters

Parameters	Min	Max
Temperature - Typical Range	-240 °C	288 °C
Maximum speed	-	2 m/s
Maximum Pressure	-	6.9 MPa