

### Material properties Type **Standard S**

- In cold rolled version
- Standard profiles are generally sandblasted
- Profile made from high-quality steel in UNI FE 360 B
- Production-related straightness  $\pm 1,0$  mm/meter.
- $L_{\max}$  = Maximum production length 12m

### Technical drawing **Standard S**

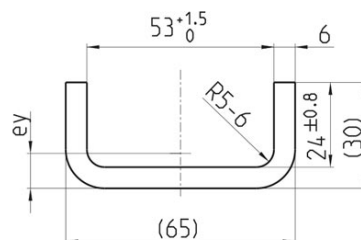

Resistance Moments **Standard S**

Article number	m kg/m	A cm <sup>2</sup>	I <sub>x</sub> cm <sup>4</sup>	W <sub>x</sub> cm <sup>3</sup>	I <sub>y</sub> cm <sup>4</sup>	W <sub>y</sub> cm <sup>3</sup>	e <sub>y</sub> cm	L <sub>max</sub> in m
113.002.000	5,3	6,40	5,00	2,50	34,90	10,70	1,00	12

**m** = mass, **A** = surface, **I<sub>x</sub>** = surface moment, **W<sub>x</sub>** = resistance moment, **I<sub>y</sub>** = surface moment, **W<sub>y</sub>** = resistance moment, **e<sub>y</sub>** = distance measure of the y-angle, **L<sub>max</sub>** = Maximum production length



## Matching Clampflange: KF S

Article No. 290.002.000

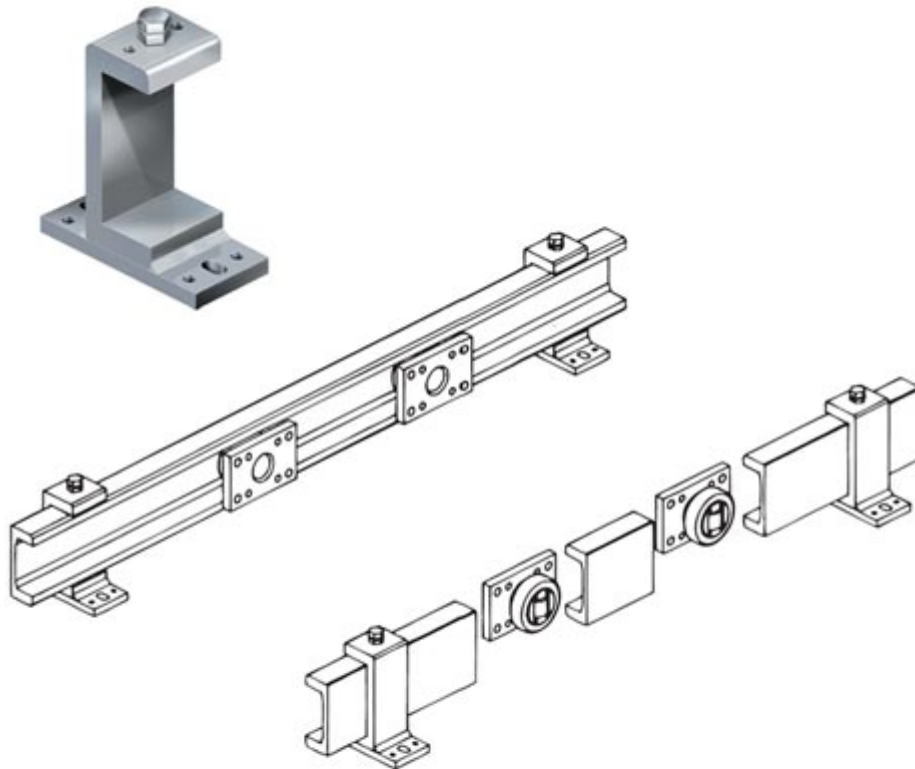

### Technical dimensions Clamp flange KF S

H	B	L	S	J	e	g	t	a1	d1	M	Gewicht kg
83	50	100	8	67	41	40	8	70	12	M8	0,70

H = Height clamp profile, B = Width clamp flange, L = Length clamp flange, S = mounting flange strength, g = Width clamp profile, t = Strength clamp profile, a1 = Distance pin hole, b1 = Distance pin hole, d1 = Diameter pin hole, d2 = Width slotted hole, d3 = Length slotted hole, e1 = Distance pin hole, M = Thread